

# Evaluation of Physical Barriers – RCA Office

Address: 3403 Tenth Street, Suite 320, Riverside, 92501

Evaluation Date: 07-19-2021

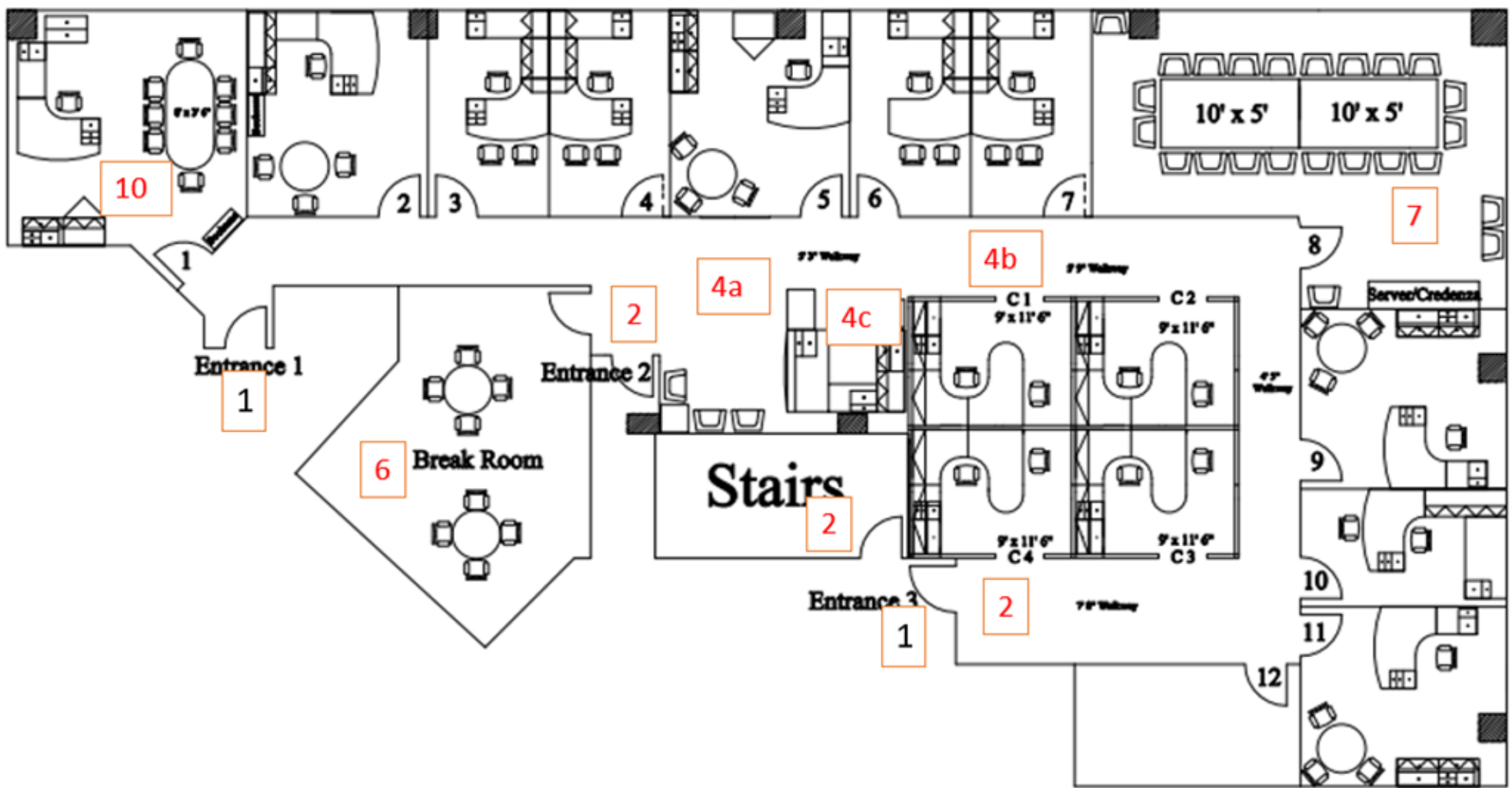

FLOOR PLAN OF RCA OFFICE- 3<sup>rd</sup> Floor

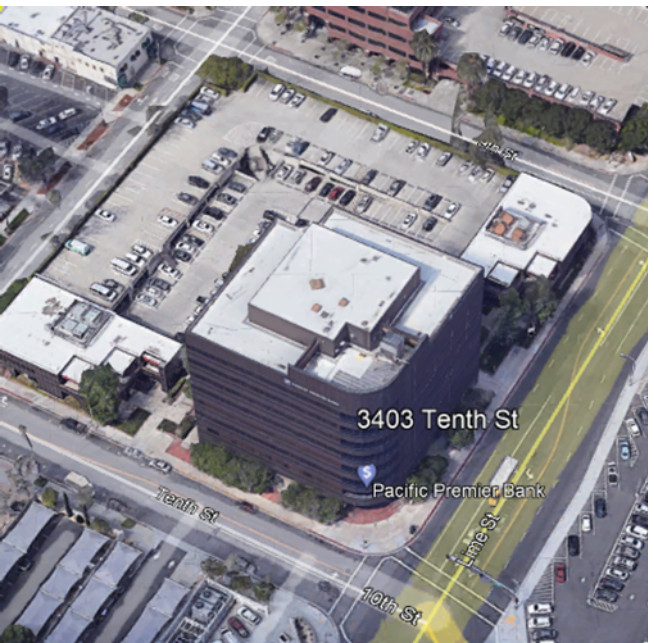

These elements were assessed to identify any physical barriers:



1. Entry doors
2. Exit doors
3. Exterior Accessible route (not shown)
4. Common Use Areas
  - a. Entry Lobby
  - b. Corridors
  - c. Print room
  - d. Controls for light, thermostat, etc.
5. Restrooms (Not applicable)
6. Break room
7. Conference Room/Meeting room
8. Fire Alarm (not shown)
9. Signage (not shown)
10. Private Offices

**Year Leased:** 2007

**Applicable ADA Standards:** DOT's ADA Standards (2006) and, SOC: DOJ 2010 ADA Standards.

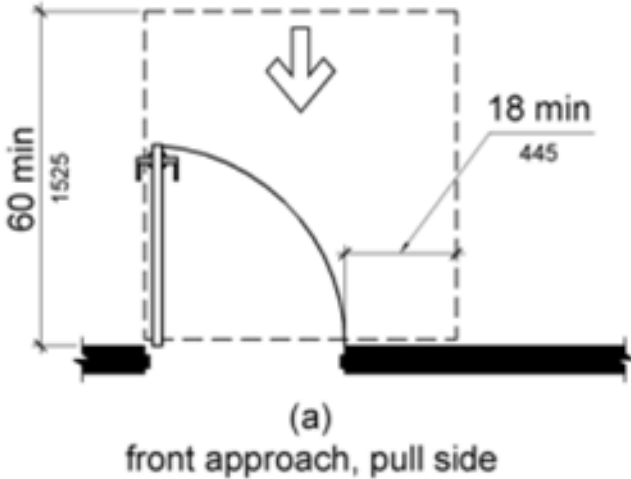
**Note:** Criteria used to assess the elements were based on DOJ 2010 standards, DOT's ADA standards (2006).

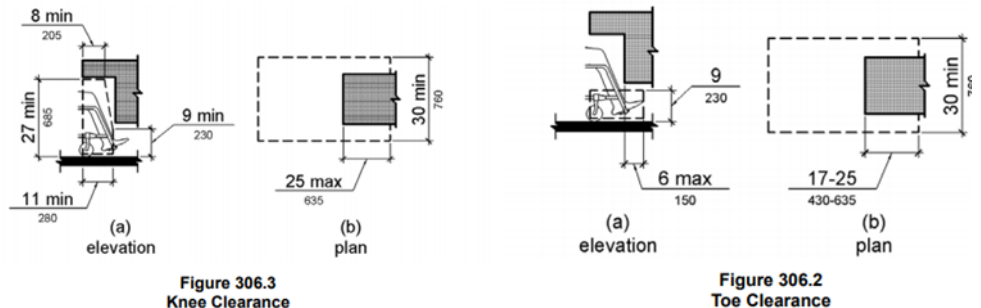
Issues/ Barriers Identified	Recommendations	Comments/ ADA Requirements
<b>1. Entry Doors</b>		
I. ISA sign is missing at accessible entry doors. Directional sign pointing to accessible route is missing at the inaccessible main door	Provide ADA compliant signage at accessible entry doors, exit doors, and provide directional signage at all inaccessible doors	216.6 Entrances. Where not all entrances comply with 404, entrances complying with 404 shall be identified by the International Symbol of Accessibility complying with 703.7.2.1. Directional signs complying with 703.5 that indicate the location of the nearest entrance complying with 404 shall be provided at entrances that do not comply with 404. 216.4.3 Directional Signs. Signs required by section 1003.2.13.6 of the International Building Code (2000 edition) or section 1007.7 of the International Building Code (2003 edition) (incorporated by reference, see "Referenced Standards" in Chapter 1) to provide directions to accessible means of egress shall comply with 703.5.
<b>2. Exit Doors</b>		
I. The accessible door with closer (near the stairs) closes too fast	Adjust door closers on all doors on the accessible route.	404.2.8 Closing Speed. Door and gate closing speed shall comply with 404.2.8. Door closers and gate closers shall be adjusted so that from an open position of 90 degrees, the time required to move the door to a position of 12 degrees from the latch is 5 seconds minimum
II. Maneuvering clearance to the breakroom door from inside is blocked by the water dispenser. Access to the paper towel dispenser is also blocked.  	Relocate water dispenser to provide 18 inches on latch side per 404.2.4 for times when a closed door needs to be opened from inside.	
<b>3. Exterior Accessible route</b>		No issues found. Maintenance of exterior route to the building is the responsibility of County of Riverside who lease the third floor to RCA

Issues/ Barriers Identified	Recommendations	Comments/ ADA Requirements
<b>4. Common Use Areas</b>		
a. Entry Lobby		
i. Knee and toe clearances are not adequate at the reception desk 	Provide accessible writing/working surface at the reception counter that is available to general public.	 <p>226.1: Where work surfaces are provided for use by other than employees, at least 5 percent shall comply with 902</p>
ii. Wheelchair space is not provided in the lobby 	Relocate furniture to allow space for at least one wheelchair or (5% of the total number of chairs , whichever is higher)	
b. Corridors		No issues found
c. Print Room		The printers and other electronic equipment were not assessed. The printers are standard models purchased from name brand manufacturers and assumed compliant with universal design requirements. RCA has moved away from print documents and more towards electronic copies, for example all agreements are done in PDF and electronically signed.
d. Controls for lighting and thermostats etc.		Access to thermostat is blocked by the printer
<b>5. Restrooms</b>		Not Applicable in this facility. Restrooms are maintained by the County of Riverside

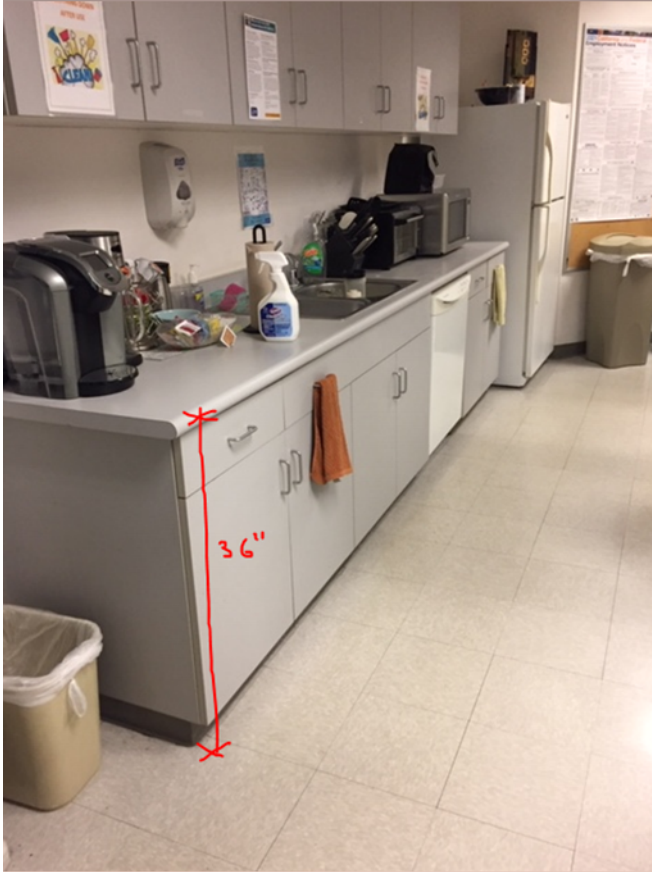
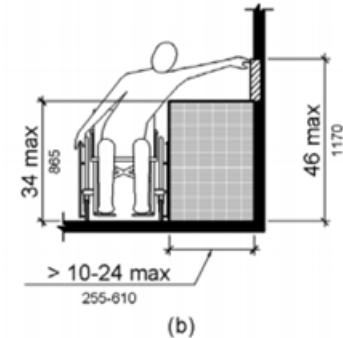

Issues/ Barriers Identified	Recommendations	Comments/ ADA Requirements
<p><b>6. Break Room</b></p> <p>i. <b>Break Room Counters:</b> Obstructed high side reach over 36 inch high and 25.5 inch deep break room counter does not comply with 308.3.2.</p> 	<p>Modify break room counters to allow compliant access to the sink faucet and operable parts/ controls that are at the back of counters</p>	<p>308.3.2 Obstructed High Reach. Where a clear floor or ground space allows a parallel approach to an element and the high side reach is over an obstruction, the height of the obstruction shall be 34 inches (865 mm) maximum and the depth of the obstruction shall be 24 inches (610 mm) maximum.</p>  <p>308.3.2</p>
<p>ii. A 36 inches wide accessible route to the break room counter is not available due to chairs and tables.</p>	<p>Relocate furniture to provide an accessible route.</p>	
<p><b>7. Conference Meeting Rooms</b></p>		<p>No issues found</p>
<p><b>8. Fire Alarm</b></p>		
<p>Fire alarm devices shall be tested for compliance to ADA standard 702.1</p>		<p>It is assumed that permanently installed audible and visible alarms comply with NFPA 72 and California building code requirements, and that maintenance and testing are performed by trained persons to ensure safe and reliable operations of the system.</p> <p>ADA Standards require that the maximum allowable sound level of audible notification appliances complying with section 4-3.2.1 of NFPA 72 (1999 edition) shall have a sound level no more than 110 dB at the minimum hearing distance from the audible appliance.</p>

Issues/ Barriers Identified	Recommendations	Comments/ ADA Requirements
<b>9. Signage</b>		
i. ADA compliant exterior identification sign and ISA sign is missing at the main accessible entry door.	Provide ADA Compliant identification sign and International Symbol of Accessibility (ISA) sign at accessible entry doors with visual and tactile characters	216.2 Designations. Interior and exterior signs identifying permanent rooms and spaces shall comply with 703.1, 703.2, and 703.5.  216.6 Entrances. Where not all entrances comply with 404, entrances complying with 404 shall be identified by the International Symbol of Accessibility complying with 703.7.2.1. Directional signs complying with 703.5 that indicate the location of the nearest entrance complying with 404 shall be provided at entrances that do not comply with 404.
ii. Interior signs on permanent rooms do not comply with 216	Provide new ADA compliant room indicator signs with visual and tactile characters at all permanent common use spaces	216.2 Designations. Interior and exterior signs identifying permanent rooms and spaces shall comply with 703.1, 703.2, and 703.5. Where pictograms are provided as designations of permanent interior, the pictograms shall comply with 703.6 and shall have text descriptors complying with 703.2 and 703.5.
iii. ADA compliant signs identifying accessible means of egress doors are missing.	Provide ADA compliant exit signs at all accessible exit doors.	216.4.1 Exit Doors. Doors at exit passageways, exit discharge, and exit stairways shall be identified by tactile signs complying with 703.1, 703.2, and 703.5.
<b>10. Employee Work Areas – Private offices.</b>		No issues found. Work areas are accessible for "approach, entry, and exit,"