



RIVERSIDE
COUNTY
TRANSPORTATION
COMMISSION

SMART FREEWAY
PILOT PROJECT
Temecula/Murrieta



Week of August 18, 2025

Extended Full Closure of the Rancho California Road Loop On-Ramp for Northbound I-15 Begins Tonight

An extended **full closure** of the Rancho California Road loop on-ramp for northbound I-15 in Temecula is scheduled to **begin tonight at 9 p.m. through Monday, August 25 at 5 a.m.** This extended closure will allow crews to reconstruct the roadway and construct a concrete barrier on the Rancho California Road on-ramp. Additionally, the on-ramp will be reconfigured and realigned to create a merge point between the Rancho California Road direct and loop on-ramp.

Detour routes will be posted. For more information, visit our closure page below:

Closure
Details

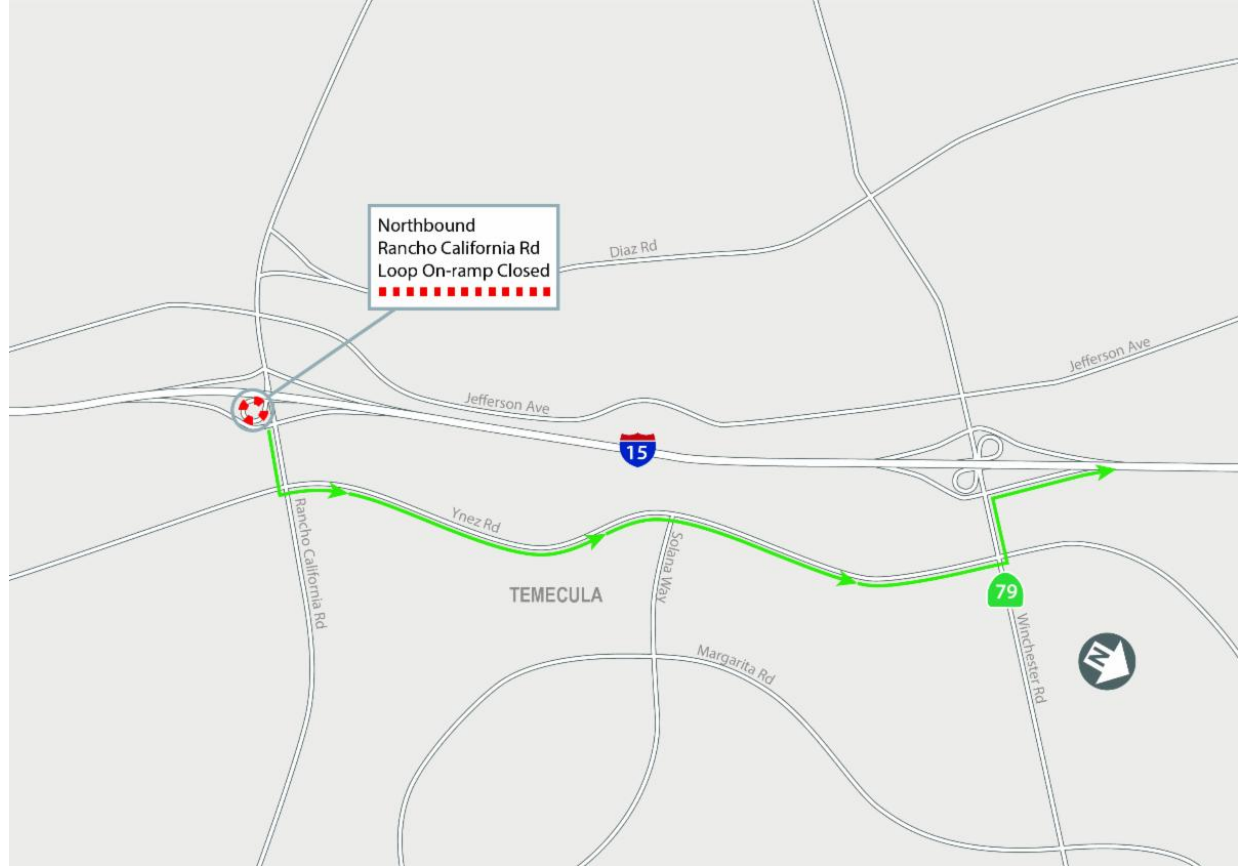

The I-15 Smart Freeway Pilot Project will also require nightly northbound I-15 lane reductions throughout the week of August 18, 2025.

Please see closure details below. Construction activity and closures are subject to change due to inclement weather and other factors.

Highway Closures and Ramp Closures

Date/Time	Activity and Location	Detour
Thursday, August 14 – Monday, August 25 9 p.m. – 5 a.m.	Northbound I-15 Rancho California Road loop on-ramp closure	East on Rancho California Road to northbound Ynez Road, west on Winchester Road to enter northbound I-15
Thursday, August 14 9 p.m. - 5 a.m.	Northbound I-15 Rancho California Road direct on-ramp closure	West on Rancho California Road to northbound Jefferson Avenue, east on Winchester Road to enter northbound I-15
Monday, August 18 – Tuesday, August 19 9 p.m. – 6 a.m.	Northbound I-215 lane reductions from the I-15/ I-215 Split to Los Alamos Rd.	No detour required, since other lanes will remain open
Wednesday, August 20 –	Northbound I-15	No detour required,

Thursday, August 21
11:59 p.m. – 5 a.m.

lane reductions from
Temecula Parkway to
Winchester Road

since other lanes will
remain open

Visit our Smart Room!

Step into the "smart"est space around. Visit our Smart Room to explore the innovation and technology behind the project.

Smart Room

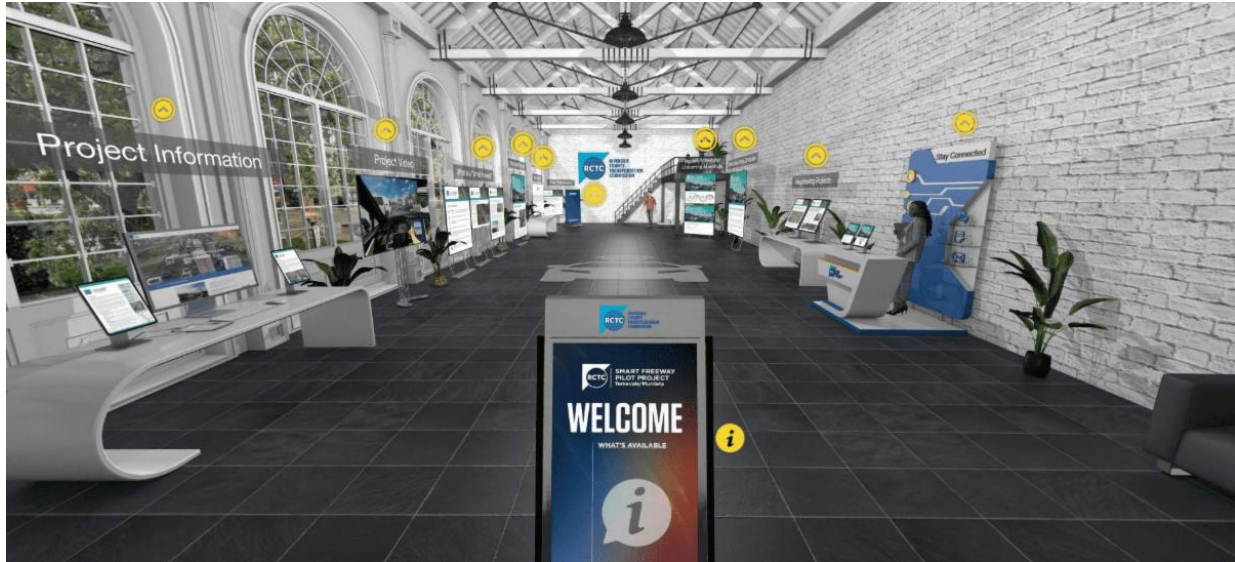

Neighboring Projects

I-15 Temecula Auxiliary Lanes Project: The California Department of Transportation (Caltrans) is constructing auxiliary lanes, and implementing other transportation system upgrades between Temecula Parkway to just north of Winchester Road on I-15. For more information, please visit the [Caltrans District 8 Webpage](#).

Project Background

RCTC, in partnership with Caltrans, the City of Temecula, and the Western Riverside Council of Governments, will be implementing an innovative technology along the northbound Interstate 15 (I-15) in Temecula and Murrieta that is anticipated to improve traffic operations.

The I-15 Smart Freeway Pilot Project will use “smart” technology to continuously monitor real-time traffic conditions along northbound I-15 in Temecula. This section of northbound I-15 encounters high traffic congestion from cars entering the Temecula Parkway, Rancho California Road, and Winchester Road on-ramps during peak afternoon and evening hours. The coordinated system will improve traffic flow by adjusting the optimal number of vehicles to enter and efficiently travel on the I-15.



Stay Connected



(800) 537-9535



rctc.org/smartfreeway



smartfreeway@rctc.org



@TheRCTC

Riverside County Transportation Commission | 4080 Lemon Street 3rd Floor | Riverside, CA 92501
US

[Unsubscribe](#) | [Update Profile](#) | [Constant Contact Data Notice](#)