



RIVERSIDE
COUNTY
TRANSPORTATION
COMMISSION

SMART FREEWAY PILOT PROJECT Temecula/Murrieta



Week of June 9 - Revised I-15 Closures

The I-15 Smart Freeway Pilot Project will require lane reductions of northbound I-15 as well as on-ramp closures of Rancho California Road and Temecula Parkway during the week of June 9.

Please view closure details below as they have been updated and marked in red. Construction activity and closures are subject to change due to inclement weather and other factors.

Closures and Ramp Closures

Date/Time	Activity and Location	Detour
Monday, June 9 – Thursday, June 12 (Wednesday, June 11) Nightly, 8 p.m. – 5 a.m. <hr/> Friday, June 13 9 p.m. – 6 a.m.	Northbound I-15 Rancho California Road loop on-ramp closure	East on Rancho California Road to northbound Ynez Road, west on Winchester Road to enter northbound I-15
Monday, June 9 – Thursday, June 12 (Wednesday, June 11) Nightly, 8 p.m. – 5 a.m. <hr/> Friday, June 13 9 p.m. – 6 a.m.	Northbound I-15 Rancho California Road direct on-ramp closure	West on Rancho California Road to northbound Jefferson Avenue, east on Winchester Road to enter northbound I-15
Wednesday, June 11 – Friday, June 13 (Thursday, June 12) Nightly, 9 p.m. – 6 a.m. Nightly, 8 p.m. – 5 a.m. <hr/> Friday, June 13 9 p.m. – 6 a.m.	Northbound I-15 Temecula Parkway On-Ramp	Temecula Parkway to northbound Old Town Front Street, eastbound Santiago Road, to Ynez Road to Rancho California Road to enter northbound I-15

Monday, June 9 – Thursday, June 12 Nightly, 10 p.m. – 6 a.m.	Northbound I-15 lane reductions from Temecula Parkway to Winchester Road	No detour required, since other lanes will remain open
Friday, June 13 11 p.m. – 7 a.m.		

Upcoming Full Closure of the Rancho California Direct On-Ramp for Northbound I-15

An extended full closure of the Rancho California Road direct on-ramp for northbound I-15 in Temecula is scheduled to **begin Monday, June 23 at 9 p.m. through Tuesday, July 1 at 5 a.m.** This closure will extend a second lane of the on-ramp by several hundred feet and create a safety pocket for emergency vehicles. This work will also reconfigure and realign the on-ramp to create a merge point between the loop and the direct on-ramps for Rancho California Road.

Detour routes will be posted. For more information visit our closure page below:

[Closure Details](#)

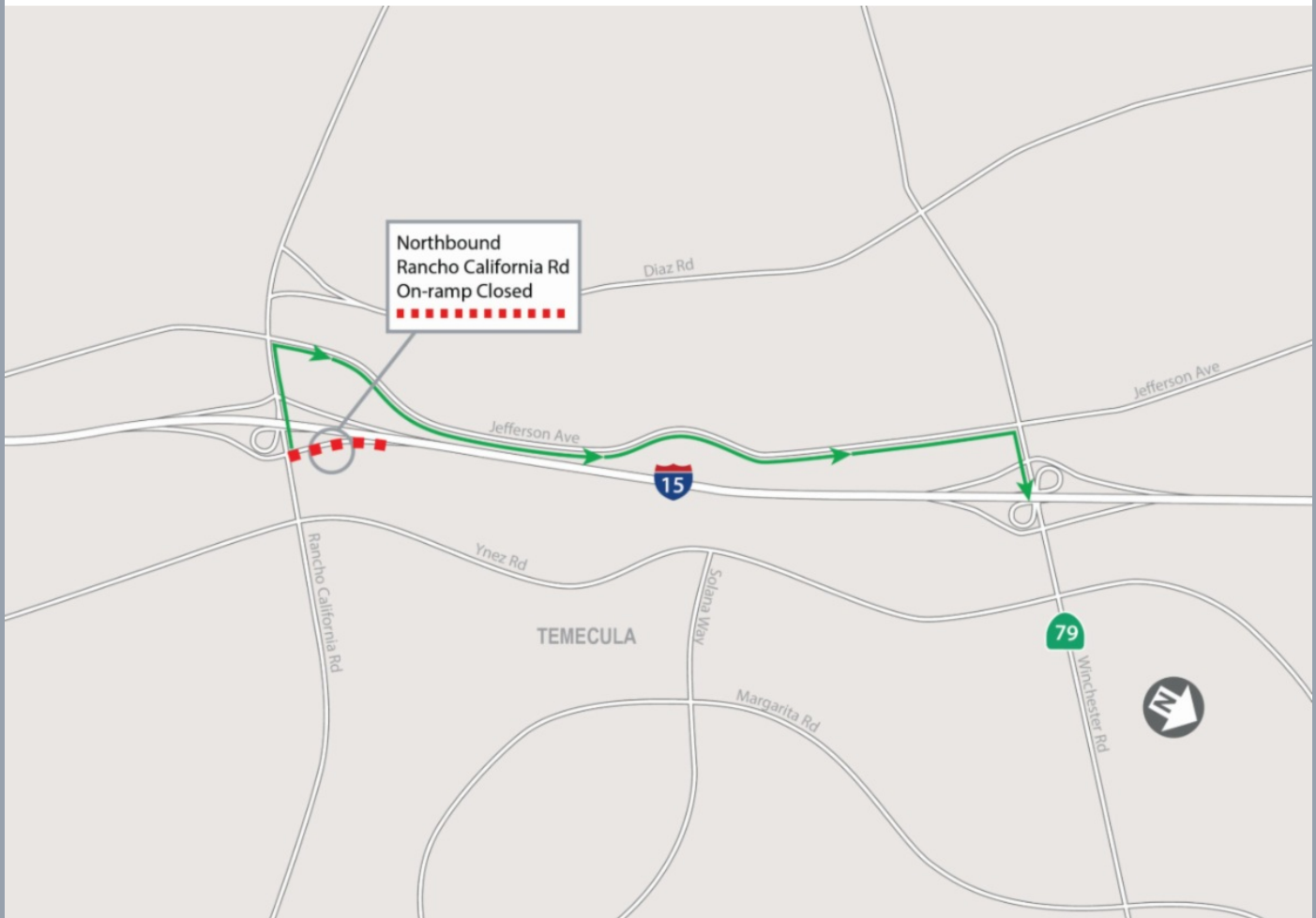

[Visit our Smart Room!](#)

Step into the "smart"est space around. Visit our Smart Room to explore the innovation and technology behind the project.

Smart Room

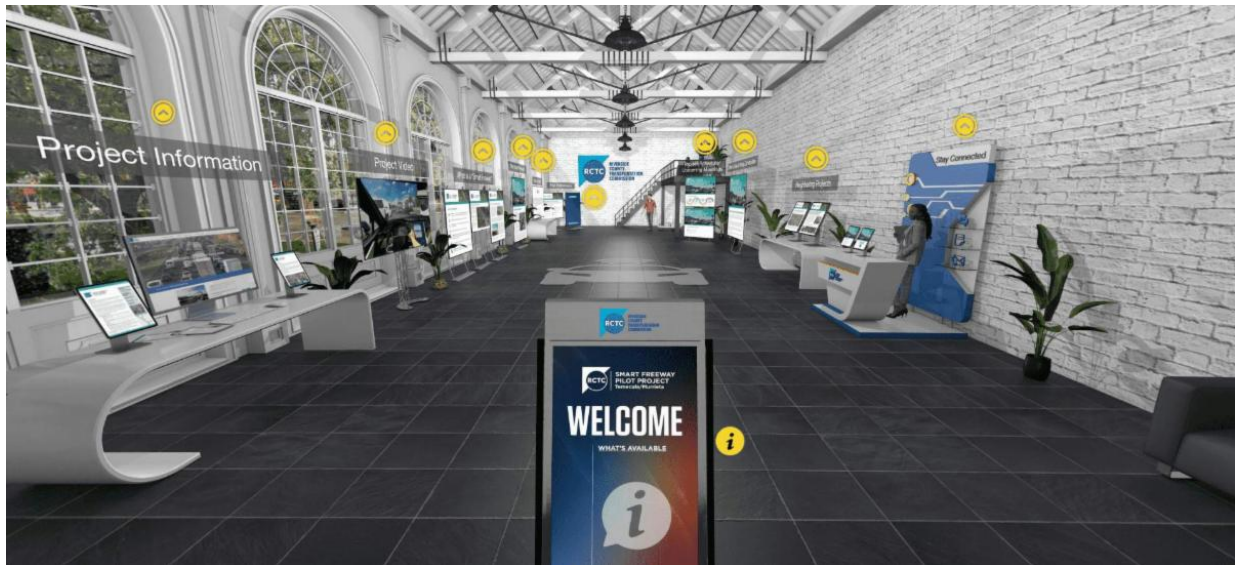

Neighboring Projects

I-15 / French Valley Parkway Improvements: Phase 2: Work is nearly complete in Temecula to reduce congestion and improve safety by relieving the I-15/Winchester Road interchange and minimizing weaving movements on I-15 between Winchester Road and the I-15/I-215 Junction. For information and construction details, please visit the [project webpage](#).

I-15 Temecula Auxiliary Lanes Project: The California Department of Transportation (Caltrans) is constructing auxiliary lanes, and implementing other transportation system upgrades between Temecula Parkway to just north of Winchester Road on I-15. For more information, please visit the [Caltrans District 8 Webpage](#).

Project Background

RCTC, in partnership with Caltrans, the City of Temecula, and the Western Riverside Council of Governments, will be implementing an innovative technology along the northbound Interstate 15 (I-15) in Temecula and Murrieta that is anticipated to improve traffic operations.

The I-15 Smart Freeway Pilot Project will use "smart" technology to continuously monitor real-time traffic conditions along northbound I-15 in Temecula. This section of northbound I-15 encounters high traffic congestion from cars entering the Temecula Parkway, Rancho California Road, and Winchester Road on-ramps during peak afternoon and evening hours. The coordinated system will improve traffic flow by adjusting the optimal number of vehicles to enter and efficiently travel on the I-15.



Stay Connected



(800) 537-9535



rctc.org/smartfreeway



smartfreeway@rctc.org



@TheRCTC

Riverside County Transportation Commission | 4080 Lemon Street 3rd Floor | Riverside, CA 92501
US

[Unsubscribe](#) | [Update Profile](#) | [Constant Contact Data Notice](#)