



RIVERSIDE
COUNTY
TRANSPORTATION
COMMISSION

SMART FREEWAY
PILOT PROJECT
Temecula/Murrieta



Upcoming Extended Ramp Closure

July 13 – July 21, 2025

Extended Full Closure of the Rancho California Road Direct On-Ramp for Northbound I-15

The Riverside County Transportation Commission's I-15 Smart Freeway Pilot Project will require an extended **full closure** of the Rancho California Road direct on-ramp for northbound I-15 in Temecula **beginning Sunday, July 13 at 9 p.m. through Monday, July 21 at 5 a.m.**

The ramp will be closed for an extended period of time to allow for safe demolition and reconstruction. The extended closure is required to extend the second lane of the on-ramp by several hundred feet and create a safety pocket for emergency vehicles. This work will also reconfigure and realign the ramp to create a merge point between the Rancho California Road direct and loop on-ramps. Later this summer, RCTC will require a similar closure of the northbound 15 Rancho California Road loop on-ramp.

For more information about the I-15 Smart Freeway Pilot Project and to sign up for construction updates, please visit www.rctc.org/temeculaclosures

CLOSURE LOCATION	DAYS/TIMES
Rancho California Road Direct On-Ramp for Northbound I-15 Fully Closed	Sunday, July 13 at 9 p.m. to Monday, July 21 at 5 a.m.

Closure dates are subject to change due to weather, site conditions, construction progress, and other factors.

NORTHBOUND I-15 RANCHO CALIFORNIA ROAD DETOUR

Motorists may travel west on Rancho California Road, northbound on Jefferson Avenue, and east on Winchester Road to enter northbound I-15.

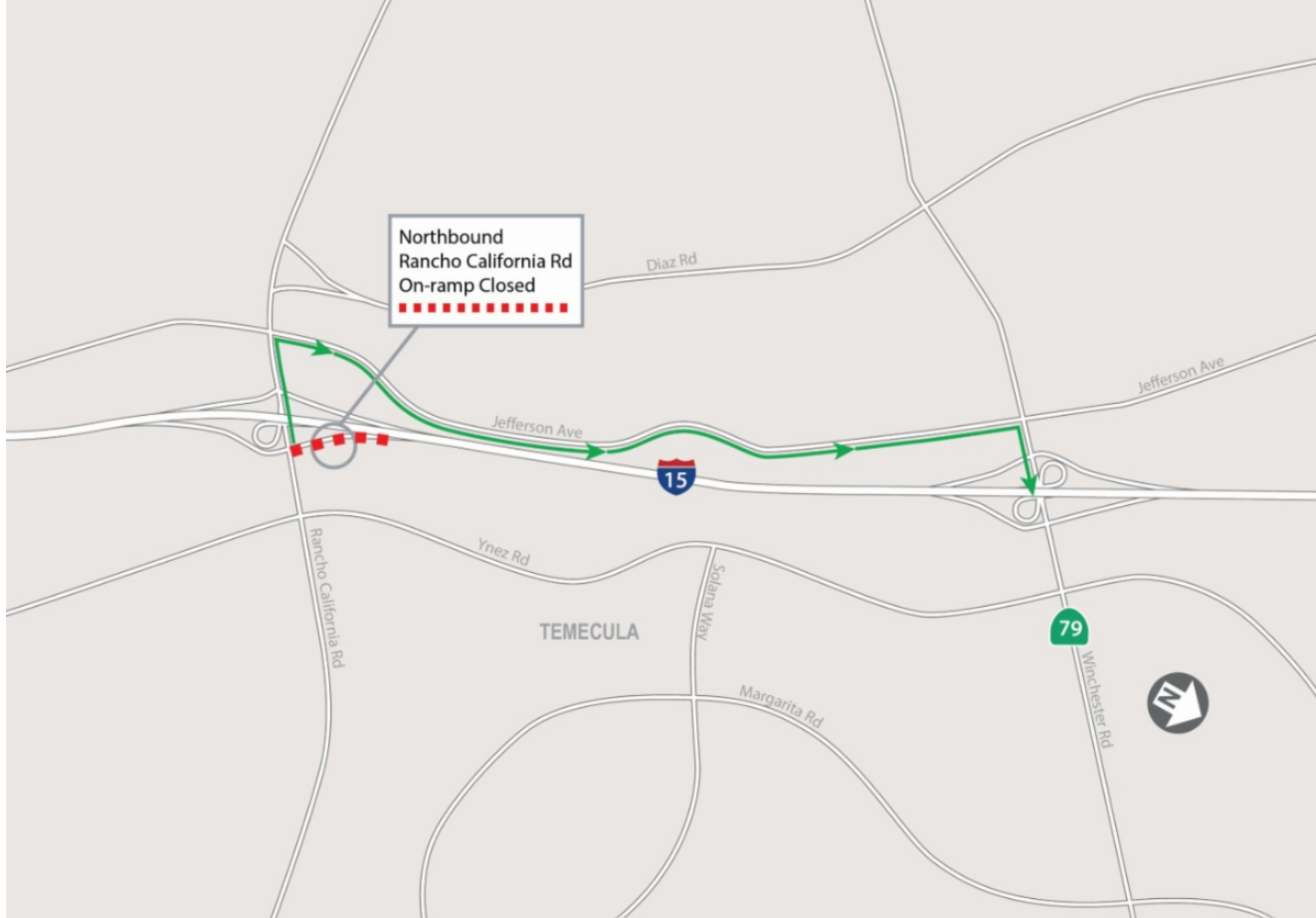

Stay Connected



(800) 537-9535



rctc.org/smartfreeway



smartfreeway@rctc.org



@TheRCTC

Riverside County Transportation Commission | 4080 Lemon Street 3rd Floor | Riverside, CA 92501
US

[Unsubscribe](#) | [Update Profile](#) | [Constant Contact Data Notice](#)